



NightWatcher

NW-4CVI-2MP (FHD) Kit

NW-8CVI-4MP (2K) Kit

NW-8CVI-8MP (4K) Kit

Digital Video Recorder

Quick Start Guide

Version 6.1.0

A full version Instruction Manual for this product is available online at NightWatcher.co.UK/Support

Contents

Safety First	3
CCTV and the law.....	3
1 Quick Start	4
What's in the box?.....	4
Checking the components.....	4
Booting up.....	4
2 The rear panel	4
3 Set-up	5
Cameras.....	5
Initializing the DVR.....	5
The Mobile app.....	7
Configuring P2P Settings.....	8
Adding DVR to the app.....	8
Configuring recording storage.....	10
Playing recorded video.....	11
4 Navigating the DVR's screens	11
5 Web operations	12
6 Trouble shooting	13
7 Support	18
8 Product Compliance	18
9 Specifications	19

Safety First

Please read this 'guide' carefully before using your DVR and keep it for future reference.

Operation Requirement

- Install the DVR indoors in normal living space.
- Do not install the DVR in a place exposed to direct sunlight, near a heat source, or in very cold conditions.
- Keep the DVR away from dampness, high humidity, dust or soot.
- Keep the DVR installed horizontally in a stable place to prevent it from falling.
- Do not drop or splash liquid onto the DVR, and make sure there is no object filled with liquid on the DVR to prevent liquid from flowing into the DVR.
- Install the DVR in a well-ventilated place, and do not block the ventilation of the DVR.
- Operate the DVR within the range of power input and output (according to rating labels).
- Do not disassemble the DVR.

Electrical Safety

- There is a CR1220 button cell on the PCB for providing back up power to maintain date and time etc. This will last for a long time, but when it comes time to replace it, replace with a reputable brand battery and ensure it is replaced in correct polarity (+ up).
- Please recycle exhausted batteries. Do not dispose to unsorted waste. Button cells can be lethal if swallowed, always keep them securely and out of reach of children and pets.
- Use only the 12V (SELV) power adapter provided with the DVR. Using an incorrectly specified adapter will invalidate your warranty and may present a risk of electric shock and fire.
- Do not remove or destroy the rating label(s) on the product; they contain vital safety information and data that is needed for aftersales support.

CCTV and the law

CCTV systems are subject to specific legislative restrictions in the EU/UK. You are allowed to operate CCTV systems on your own property to protect that property, but you must preserve the privacy of your neighbours and the general public.

- Do not point cameras at neighbour's windows,
- Avoid covering areas that are not your property in camera view where possible
- Do not keep recordings for longer than is necessary for security purposes
- Do not publish or display video footage out of context of security.
- Do display a 'CCTV in operation' sign within the area of your surveillance.

To avoid conflict with your neighbours, you should discuss the siting and angle of cameras with them before you install. For further details of the law on CCTV, look at our website www.nightwatcher.co.uk or directly at government websites with reference to the following legislation.

- The Protection of Freedoms Act 2012
- The Surveillance Camera Code of Practice 2013 (the 'SCOOP')
- The Data Protection Act (the 'DPA')

Help is at hand!

If at any point you are unsure or need further guidance, consult the troubleshooting section at the end of this instruction, the FAQs on our website or contact our support centre. See www.nightwatcher.co.uk for details.

1. Quick Start

What's in the box?

1. DVR
2. USB Mouse
3. UK 3 pin mains adapter
4. HDMI lead
5. LAN cable
6. Instruction manual

Booting up



CAUTION

Ensure the output voltage/ampereage on the adapter corresponds to the power requirement of the DVR.

1. Connect the DVR to a display.
2. Plug in the power cable to the DVR.
3. Connect your cameras to the DVR (see camera instructions for details)
4. Press the power button to turn on the DVR. The power indicator glows. On the connected display, the live view screen is displayed.

2. The front panel

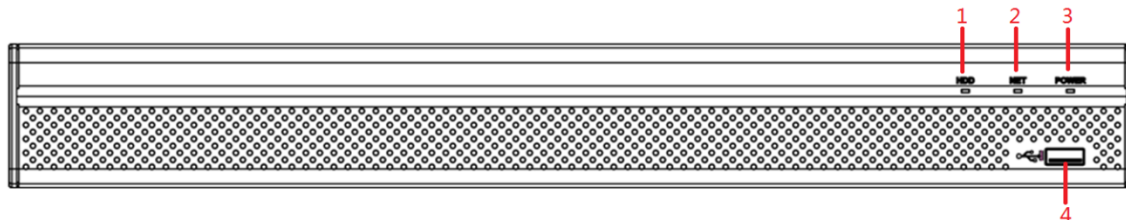

Figure 1-1

No.	Port Name	Function
1	HDD	Glow blue when HDD status is abnormal.
2	NET	Glow blue when network status is abnormal.
3	POWER	Glow blue when the power is connected properly.
4	USB port	Connects to peripheral devices such as USB storage device, keyboard and mouse.

3. The rear panel

The following figure shows the rear panel of model with 4 video input ports (as an example).

NW-2CVI-2MP

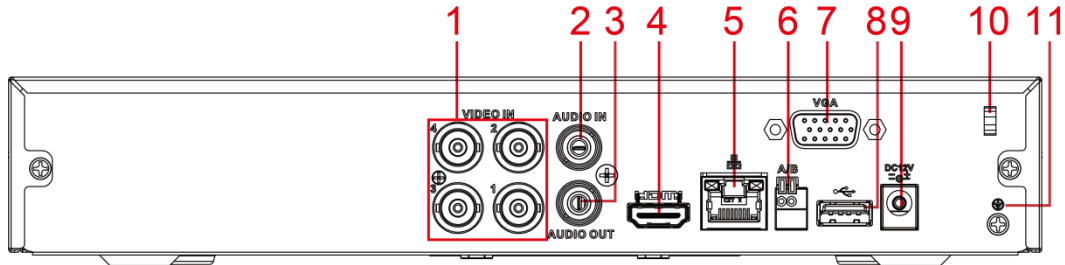

NW-8CVI-8MP

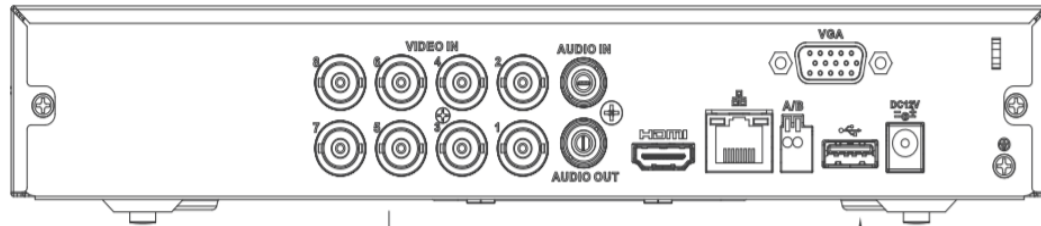

No.	Port Name	Function
1	Video input ports	Connects to analog camera to input video signal.
2	Audio input port	Receives audio signal output from the devices such as microphone.
3	Audio output port	Outputs audio signal to the devices such as the sound box.
4	HDMI port	High definition audio and video signal output port. The port outputs the uncompressed high definition video and multi-channel audio data to the connected display with HDMI port.
5	Network port	Connects to Ethernet port.
6	RS485 communication port	Connects to the control devices such as speed dome PTZ. RS485_A port is connected by the cable A and RS485_B is connected to the cable B.
7	VGA port	Outputs analog video data to the connected display with VGA port.
8	USB port	Connects to external devices such as USB storage device, keyboard and mouse.

No.	Port Name	Function
9	Power input port	Inputs DC 12V power.
10	Power cable fastener	Use clamp to secure the power cable on the DVR in case there is any loss.
11		Ground terminal.

 NOTE

- To enter the Main Menu, right-click on the live view screen to display the shortcut menu, and then click **Main Menu** and login the system.
- In order to make use of **network services** such as peer to peer camera viewing on your mobile phone, you need to connect your DVR to your network router. This DVR does not support wifi, so this must be done via the LAN cable supplied to the network port (5 in the diagram above). See also internet connection and P2P on P7.

4. Set-Up

Cameras

For details on siting fitting and set-up of cameras see the separate camera instructions that come with your NightWatcher cameras. Connect the camera leads for your cameras to the back panel via the BNC connectors (item no.1 in the back-panel diagrams).

Set the recording resolution in Camera>Encoding>Resolution during or after Initializing the DVR.

Note that the the substream options define the bandwidth fed to the app, rather than direct connection, which is the mainstream.

Initializing the DVR

When booting up for the first time, the **DVR Initialization** interface is displayed. You need to configure the password information for '**admin**'. If needed, you can also configure an unlock pattern and password protection mode (see password parameters table below).

 NOTE

Use your mouse to click on the spaces to activate the onscreen keyboard. Your password can be set from 8-32 characters and should contain at least 2 types of character, e.g. number and letter, letter and special characters (excluding inverted commas).

Leave yourself a clue to your password in the prompt field

Device Initialization

1. Enter Password → 2. Unlock Pattern → 3. Password Protection

User admin

Password Use a password that has 8 to 32 characters, it can be a combination of letter(s), number(s) and symbol(s) with at least two kinds of them

Confirm Password (please do not use special symbols like ' " ; : &)

Prompt Question

Next

Note your login e-mail and password here for future reference

E-mail	Password

Now enter your recovery e-mail address and security answers for password reset. If you don't want to, do this you can disable these features with the toggle switches.

Device Initialization

1. Enter Password → 2. Unlock Pattern → 3. Password Protection

Email Address To reset password, please input properly or update in time

Security Questions

Question 1 What is your favorite children's book?

Answer

Question 2 What was the first name of your first boss?

Answer

Question 3 What is the name of your favorite fruit?

Answer

Save

Password Protection Mode	Description
Email Address	In the Email Address box, enter an email address for password reset. In the event that you forget your password you can get a reset sent to this address. You will be asked to enter the security code sent to this reserved email address to reset the admin password.
Security Questions	Configure the security questions and answers. In case you forget your password, enter the answers to the security questions that will be used when you reset the password.
 NOTE <i>If you want to configure the email or security questions function or change the configuration later, select Main Menu > ACCOUNT > USER> then click the edit icon.</i>	

Auto-check for updates ✓

In order to keep your DVR up to date with developments, bug fixes and security updates, please update your DVR when advise to do so by the operating system. These updates ensure the smooth running of your system. So please leave the auto-check for updates, ticked.

General

There is no need to change any of the settings in the General screen for a standard set-up, but note down the device name and its useful to enable the Navigation bar for easy access to main menu options in live view.

Date and time

For use in the UK this should be set for GMT 00.00 Greenwich Mean Time. To set the DVR to automatically adjust for changes to and from British Summer time just set the DST switch to ON (regardless of what time of year it is). The start and end times for the auto-DST are factory set to March/Last/Sunday/1.00 and end time to October/last/Sunday/2.00 (for UK use). If you are setting up outside the UK you may need to adjust these to national settings.

Changes in this screen will not take effect until you press next.

You can also set the date format (DDMMYYYY, YYYYMMDD etc,) in this screen.

Network

Network is set-up to be as automatic as possible. You shouldn't need to change anything here. DHCP (Dynamic Host Configuration Protocol) is enabled as a default. This should set up your IP address automatically and works well for most common UK routers. If your internet connection does not work after a basic set-up, you may need to disable DHCP and set up your IP address manually.

Internet connection

It is only necessary to connect your DVR to your router if you want to make use of the mobile app services. This allows you to view your cameras remotely via your phone. Connect one end of the LAN cable supplied with this DVR to the Network Port (5 in the rear-panel diagram) and the other end to your router. If you DVR is not located conveniently close to your router you will need to connect your DVR to a network device which allows it to connect to your router remotely. Such devices typically use the house's wiring to conduct signal or else use wifi technology to provide a remote wired LAN connection.

The mobile app – Lite version

Download the Easy Viewer (Lite) mobile app from the Apple app store or from the Google play store and install it.

The screenshot below is from the Google Play Store

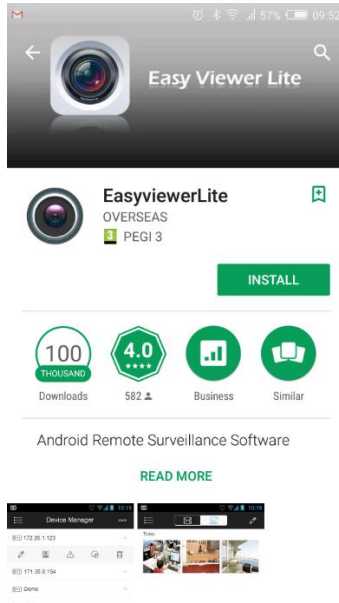

The Lite version is free and allows you to view your cameras (individually or in groups) remotely from your mobile device (smartphone or tablet) on wifi or mobile data connection.

Upgrade to Easy Viewer Pro /Easy Viewer Plus

The full app is called Easy Viewer Pro on Android (Google Play Store) and Easy Viewer Plus on IOS (Apple Store). There is a small one-off fee for purchasing these apps. The full app has extra functionality much of which is not relevant to the NightWatcher starter kits (pan/ tilt/ zoom controls etc. for PTZ cameras) but the key feature is it enables **push notifications** to your phone from your DVR. This means you can set your system to send alerts to your phone when certain trigger criteria are met. You can set up notifications from motion detection, cross-line (IVF) or face detection triggers. We recommend using the cross-line function in the IVF feature on your DVR for this, as it gives fewer alerts than MD.

MD can also be used in areas where there are not likely to be many false triggers, and is easier to set up.

Face detection only works at very short range and has no practical benefit over cross-line triggering

There are further options to view the alert as a still image, recorded incident video or live video from this type of push notification. Thus, you can see what triggered the camera, or view what is happening right now from the camera that triggered through your mobile device anywhere you have mobile data or wifi connection.

For full details on this feature see the Full Manual online - section Push Notifications

Configuring P2P Settings



NOTE

Make sure the DVR is connected into the Internet, and if yes, in the **Status** box of the P2P interface, it shows **Online**.

You can add the DVR into your cell phone client or the DVR's P2P platform to manage

Entering P2P Interface

1. Select **Main Menu > NETWORK > P2P**, the **P2P** interface is displayed.

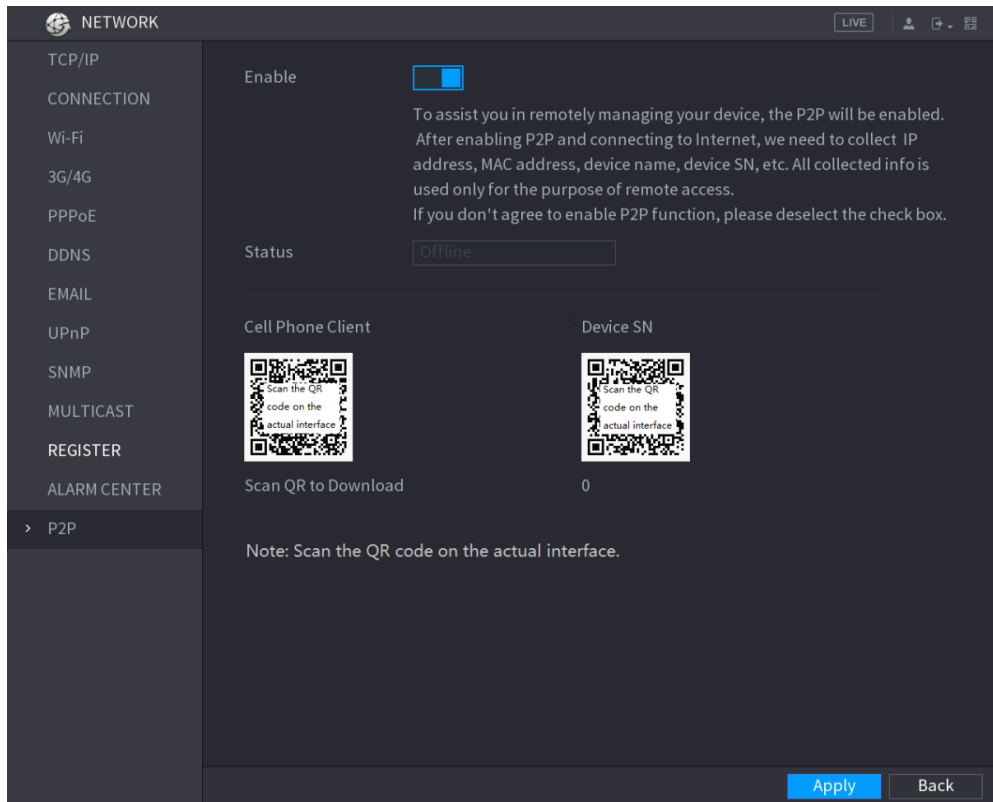

2. Enable the P2P function.
3. Click **Apply**. You can start adding the DVR into Cell Phone Client or the platform.

Adding the DVR into the Cell Phone Client-(mobile app)

Note that the American term 'cell phone client' meaning mobile application ('app') is used in the DVR's software.

To use P2P (Peer to peer) function, take adding wired DVR into Cell Phone Client as an example.

4. Use your cell phone to scan the QR code under **Cell Phone Client** to download the application. Or go to the app store to download Easy Viewer (Lite) mobile app from the Apple app store or from the Google play store and install it.
5. Open the application and tap , the menu is displayed.
6. Tap **Device Manager > >Add Device**, the **Add DVR** interface is displayed. Tap **Wired device**.

7. Tap **P2P**, enter your own name for the DVR, then enter your username and password, scan the QR code under **DVR SN**, and then tap **Start Live Preview**. The DVR is added and displayed on the live view interface of the cell phone.

Tip

To view a single camera in full screen from the mobile app, double tap the screen segment you want to view and double tap to exit full screen

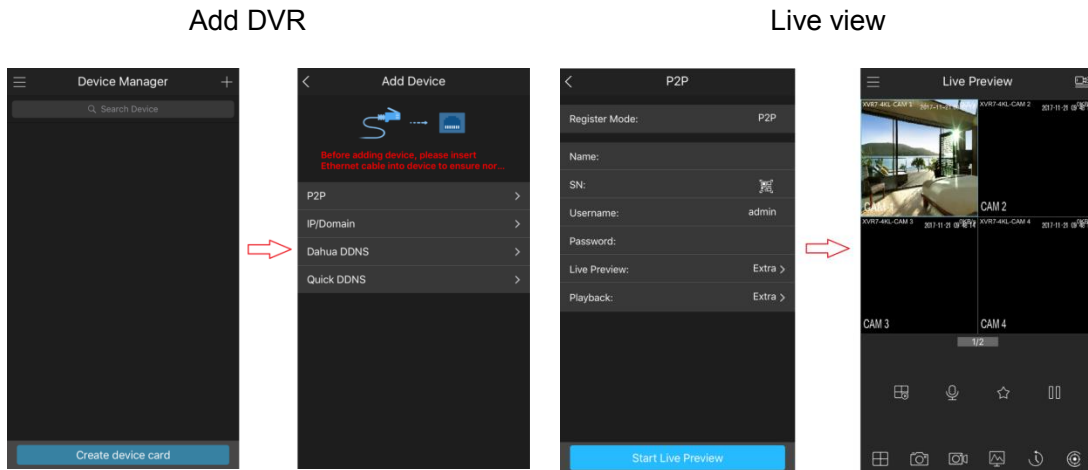

■ Logout

On the top right of the Main Menu interface or any interface after you have entered the

Main Menu, click .

- Select **Logout**, you will log out the DVR.
- Select **Reboot**, the DVR will be rebooted.
- Select **Shutdown**, the DVR will be turned off.

You can also press the power button on the DVR to turn it off.

Encode

In the **Camera>Encode** menu you set up your recording settings.

Recording Resolution

The DVR will automatically recognize the installed cameras and set the maximum recording resolution offered by the camera/DVR combination. Note also that max recording resolution is limited not only by the camera's resolution, but also by the DVR to a maximum determined by the model.

NightWatcher kit	Max. resolution offered by DVR	Max. resolution offered by Cameras in the kit	Max. recording resolution offered by kit
NW-4CVI-2MP	1920x1080 (FHD)	1920x1080 (FHD)	1920x1080 (2MP/FHD)
NW-4CVI-4MP	3840x1260 (4K)	2560x1440 (2K)	2560x1440 (4MP/2K)
NW-4CVI-8MP	3840x1260 (4K)	3840x1260 (4K)	3840x1260 (8MP/4K)

Frame rate

The DVR will also set the frame rate for you. Note that the max frame rate will depend on the resolutions set and is limited by the process rates of each DVR model. For example, on the NW-4CVI-2MP running its 4 cameras at 1920x1080 (FHD), channel 1 is set to 20 fps and channels 2,3,4 are all limited to 7 fps. The NW-8CVI DVR kits come with 8 higher resolution cameras which limits frame rate as follows.

NightWatcher kit	Default Recording resolution	Frame rate at default resolutions
NW-4CVI-2MP	1920x1080 (FHD)	Channel 1- 20fps channels 2,3,4 - 7fps
NW-4CVI-4MP	2560x1440 (2K)	All channels 15fps
NW-4CVI-8MP	3840x1260 (4K)	All channels 7fps



NOTE

Higher resolution takes more space on the drive. So, your recording time will be shorter before it starts to overwrite but you should consider that you may need to blow-up (digitally zoom) images to recover details such as faces or car number plates, so the highest resolution you can get is usually the best option.

Configuring Recording Storage Schedule

Select **Main Menu > STORAGE > SCHEDULE > Record**, the **Record** interface is displayed (see graphic below).



The default setting is 24 hours recording for all channels. You can modify the settings if needed.

Choose motion detect or continuous video

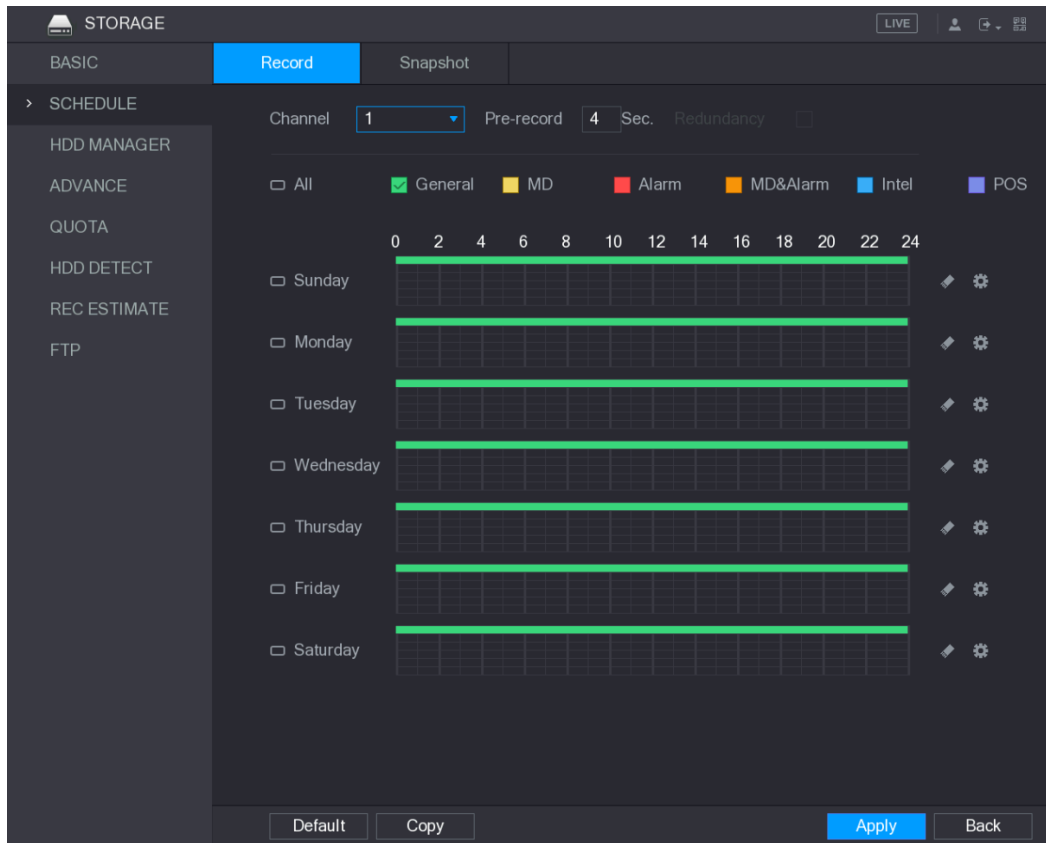
Motion detect is set as default recording mode. This means that your cameras will only record when they detect movement in front of them. This means you can record events rather than days of nothing happening. This takes much less space on the drive, so you can keep weeks of events from several cameras on your hard disk before it is overwritten by new video.



Parameter	Description
Channel	In the Channel list, select a channel to record the video.
Pre-record	In the Pre-record list, enter the amount of time that you want to start the recording in advance.
Redundancy	<p>If there are several HDDs installed to the Device, you can set one of the HDDs as the redundant HDD to save the recorded files into different HDDs. In case one of the HDDs is damaged, you can find the backup in the other HDD.</p> <ul style="list-style-type: none"> ● Select Main Menu > STORAGE > HDD MANAGER, and then set a HDD as redundant HDD. ● Select Main Menu > STORAGE > SCHEDULE > Record, and then select the Redundancy check box. <ul style="list-style-type: none"> ◇ If the selected channel is not recording, the redundancy function takes effect next time you record no matter you select the check box or not. ◇ If the selected channel is recording, the current recorded files will be packed, and then start recording according to the new schedule.

	 NOTE <ul style="list-style-type: none"> • Not all models support this function. • The redundant HDD only back up the recorded videos but not snapshots.
Event type	Select the check box of the event type which includes General , MD (motion detect, video loss, tempering, diagnosis), Alarm (IoT alarms, local alarms, alarms from alarm box, IPC external alarms, IPC Offline alarms), MD&Alarm , Intel (IVS events, face detection), and POS .
Period	Define a period during which the configured recording setting is active.  NOTE <i>The system only activates the alarm in the defined period when set.</i>
Copy	Click Copy to copy the settings to other channels.





Configure the record settings parameters. See the table below.

Table 1-1

Define the video recording period by drawing or editing. By default, it is active all the time.

- Define the period by drawing.
 - 1) Select the check box of event type. See the picture below.



- 2) Define a period. The system supports maximum six periods.
 - ◇ Define for the whole week: Click  next to **All**, all the icon switches to , you can define the period for all the days simultaneously.
 - ◇ Define for several days of a week: Click  before each day one by one, the icon switches to . You can define the period for the selected days simultaneously.
- 3) On the timeline, drag to define a period. The Device starts recoding the selected event type in the defined period. See the picture below.



The color bar indicates the event type that is effective in a defined period:

Enabling/Disabling PIR

In the **Alarm>Video Detect** menu, you can find and enable or disable the PIR setting. PIR as a setting can only be enabled on cameras that have the PIR function. It is enabled by default, however the range of the PIR sensor is lower than that of the Motion Detect.

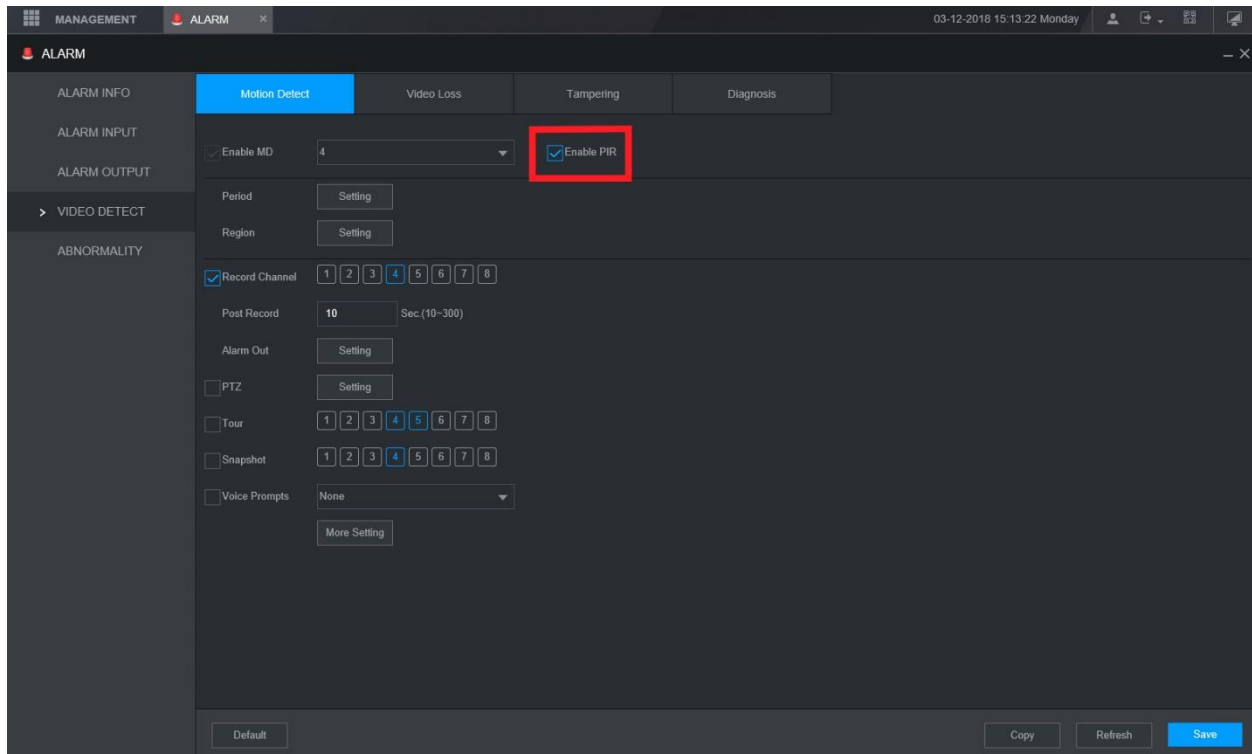

Playing Recorded Video

Select **Main Menu > VIDEO**, the video search interface is displayed. See the graphic below. You can view, search, and play back the recorded video.



To select a channel (camera) click the numbered channel bars at the bottom of the screen with your mouse. A green bar will appear, and the recording will appear in the central box. If no green bar appears, there are no recordings on that channel.

5. Navigating the DVR's screens

Once you have completed set-up (initialization) most screens have a tool bar along the top of the screen. This includes Live, the head and shoulders admin icon, logout and QR code icon. Left click 'Live' to view live feeds from the cameras.

Right click on any area (that is not a data field) gets you back to the main menu.

Right click from anywhere in main menu takes you to Live,

Left click in a blank space on any screen to get back to the main menu.

The main menu

Here you have large buttons to enter Video, Alarm, IVS, POS, Face detect and Back-up feature pages and buttons along the bottom of the screen to enter Camera, Network, Storage, System, Account, and Info submenus.

From these you can configure every part of the system, change your password, set camera resolutions and frame rates, recording schedules, revise account details, open QR codes to scan etc.

6. Web operations

Connecting to Network



NOTE

The factory default IP address of the DVR is 192.168.1.108.

The DVR supports monitoring on different browsers such as Safari, fire fox, Google, on Apple and PC to perform the functions such as multi-channel monitoring, and device parameters configurations.

Check to make sure the DVR has connected to the network.

Configure the IP address, subnet mask and gateway for the PC and the Device. For details about network configuration of the Device, see Set-up, Initialization

On your PC, check the network connection of the Device by using "ping *.*.*.*.*". Or similar network connection test. Usually the return value of Time to Live (TTL) is 255.

On your computer, open your internet browser, enter the IP address of the DVR, and then press **Enter** key. The **Login in** dialog box is displayed. See below. Enter the user name and password to login to the DVR.

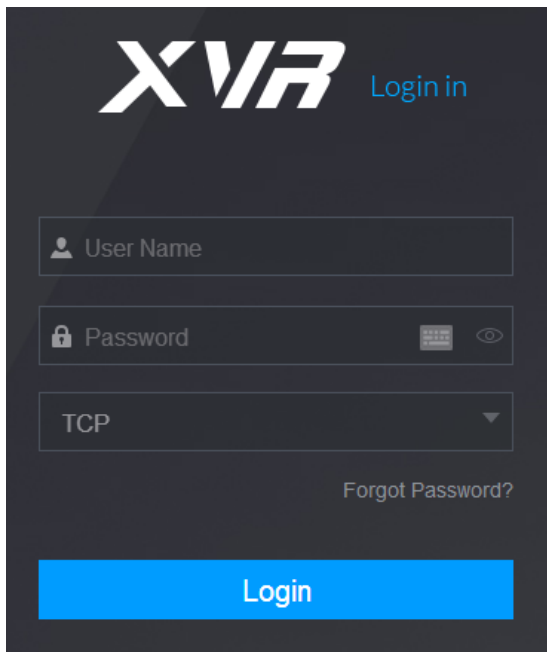

The screenshot shows a dark-themed login interface for XVR. At the top left is the 'XVR' logo in white, and to its right is the text 'Login in' in blue. Below the logo are three input fields: 'User Name' with a person icon, 'Password' with a lock icon and a toggle eye icon, and a dropdown menu currently set to 'TCP'. Below these fields is a link that says 'Forgot Password?'. At the bottom of the form is a large blue button with the word 'Login' in white text.



NOTE

DVR initialization is required at the first login.

The default administrator account is **admin**. The password is the one that was configured during initializing settings. To keep your account secure, it is recommended to keep your password securely and change it periodically (but keep it written down somewhere safe).

You can select the protocol type as **TCP**, **UDP**, or **MULTICAST** depending on the networking structure. The default is **TCP**.

If you forgot the password, click **Forgot Password?** to reset the password.

When entering the **Live** interface for the first time, follow the onscreen instructions "Please install plugins first!" to install the plugins.

7. Troubleshooting

FAQs and further information

For FAQs and additional instructions of the features of these DVRs and kits please go to www.Nightwatcher.co.uk/support

Resetting your password

You can reset the password through the QR code or the security questions.

- To reset through the QR code, make sure the Enable check box is selected in **Main Menu > SYSTEM > SECURITY > Password Reset**.
- To reset through the security questions, make sure the security questions is configured.

Enter the login interface.

- If you have configured unlock pattern, the unlock pattern login interface is displayed. Click **Forgot Pattern**, the password login interface is displayed.
- If you did not configure unlock pattern, the password login interface is displayed.



NOTE

On the unlock pattern login interface, click **Switch User** to login; or on the password login interface, in the **User Name** list, select other users to login.

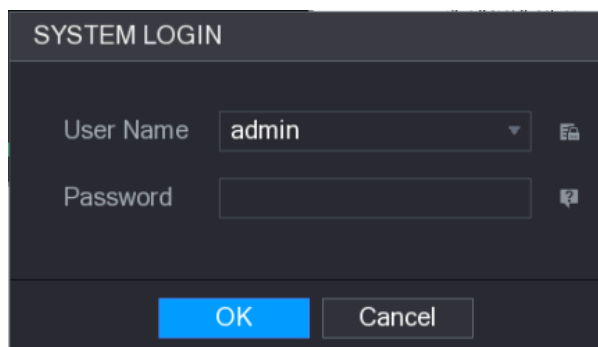
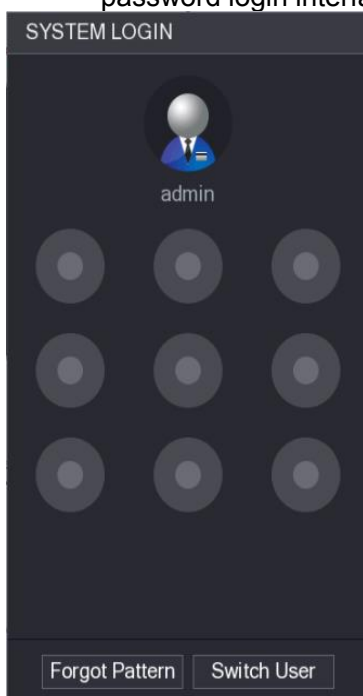

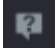
1. Click .
- If you did not set the reserved email address, the email entering interface is displayed. Enter the email address, and then click **Next**, the **Reset the password** interface is displayed.
 - If you have set the reserved email address the **reset password** interface is displayed

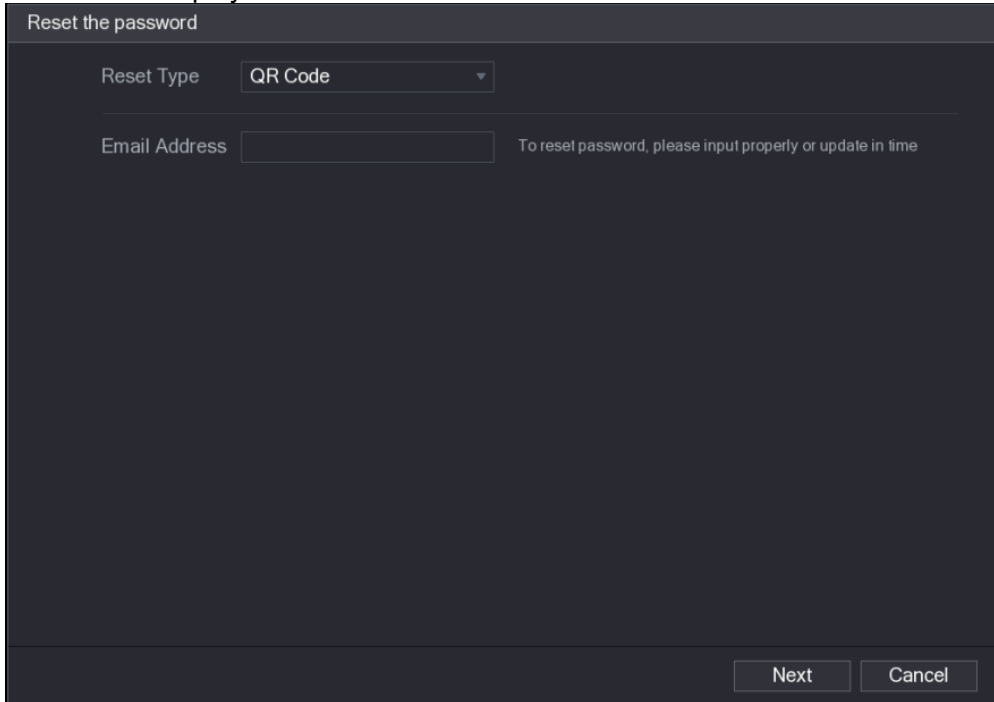

Reset the password

Reset Type

Email Address To reset password, please input properly or update in time

Next Cancel

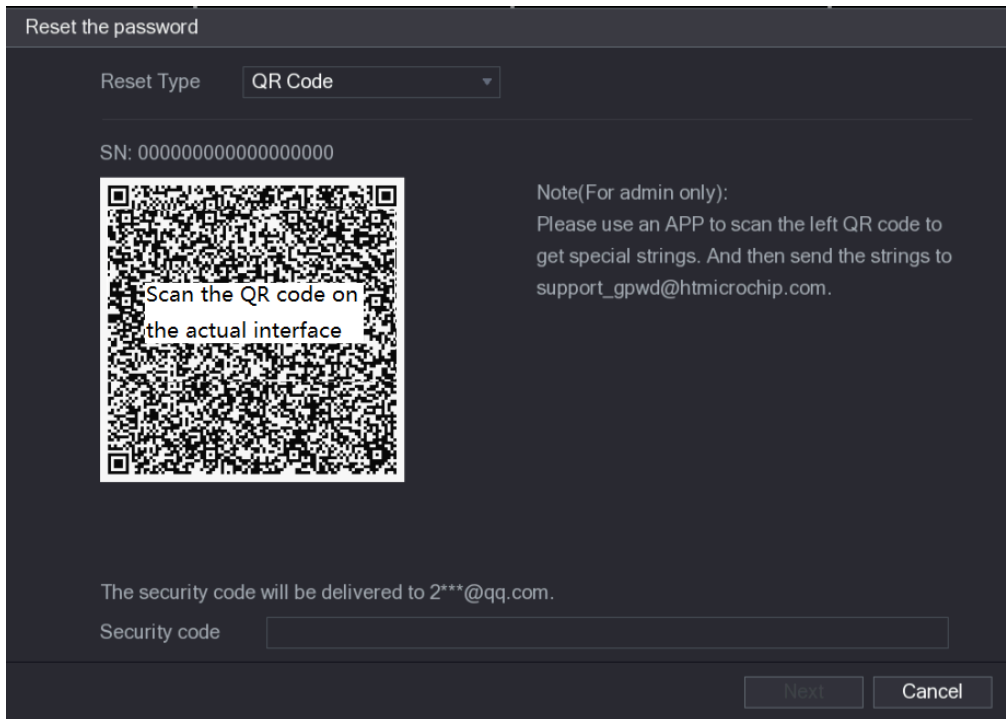

2.

Rest the password.

- QR code
Follow the onscreen instructions to get the security code in your reserved email address. In the **Security code** box, enter the security code.



CAUTION

- You are given the limited times to get the security code by scanning the QR code within 24 hours. Please operate carefully.
 - Please use the security code received in your email box to reset the password within 24 hours; otherwise the security code becomes invalid.
 - Security questions
- 4) On the **Reset the password** interface (as shown below), in the **Reset Type** list, select **Security Questions**, the Security Questions interface is displayed, see below.



NOTE

If you did not configure the security questions before, in the **Reset Type** list, there will be no **Security Questions**.

- 5) In the **Answer** box, enter the correct answers.

Reset the password

Reset Type **Security Questions** ▾

Question 1 ▾

Answer

Question 2 ▾

Answer

Question 3 ▾

Answer

Next Cancel

3. Click **Next**.
The new password resetting interface is displayed.

Reset the password

Reset password of (admin)

New Password Use a password that has 8 to 32 characters, it can be a combination of letter(s), number(s) and symbol(s) with at

Confirm Password

Save Cancel

4. In the **New Password** box, enter the new password and enter it again in the **Confirm Password** box.

5. Click **Save**. The password resetting is started.
After resetting is completed, a pop-up message is displayed.
6. Click **OK**.
A pop-up message is displayed asking if you want to sync the password with the remote DVRs, see below.
 - Click **Cancel**, the resetting is finished.
 - Click **OK**, the Sync Info interface is displayed.

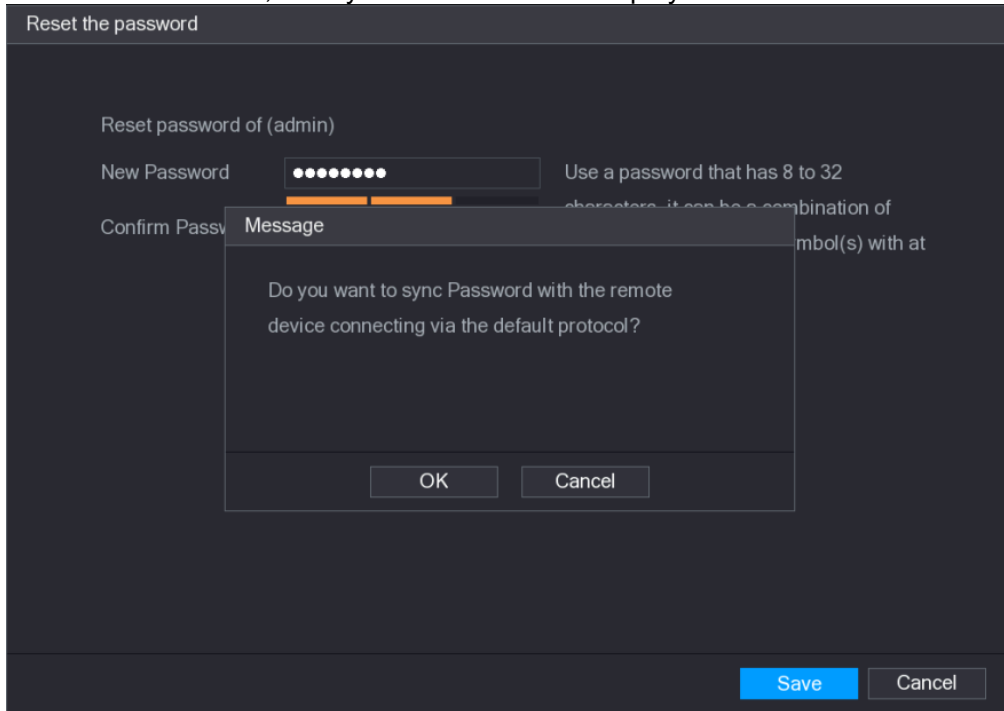

 **NOTE**

This message appears only when there are digital channels instead of complete analog channels.

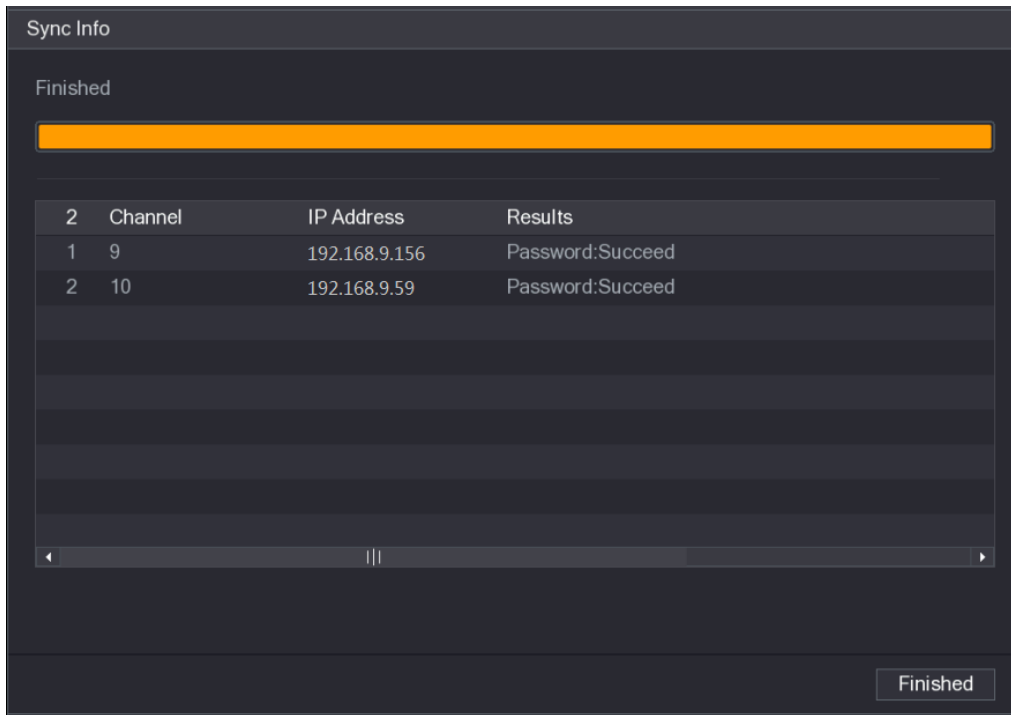

7 Support

If you have any problems with your installation, please first go to the NightWatcher web site to look at the FAQs. These are updated regularly and are laid out in product families so that they are very specific to your product.

If you can't find the answer you need there contact our call centre by e-mail or phone. See website for details and business hours.

www.nightwatcher.co.uk/support

8 Product compliance

This device complies with all relevant EU and UK regulations with regards to electrical safety and environmental protection.



Disposal instructions

Despite our best efforts at ecologically sound design and compliance with RoHS regulations, electrical products still contain many materials necessary to their efficient operation that should not

be allowed to enter the water table or otherwise pollute the Earth. So, at the end your product's life please dispose of it thoughtfully. Please don't throw it away with unsorted waste, take it to your local recycling centre (Designated Collection Facility) to be recycled as Waste electrical and electronic product. Check with your local authority for addresses and other recycling advice.

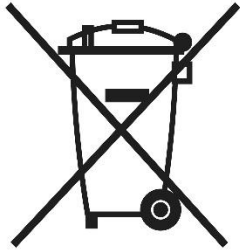

9 Specifications

NW-4CVI-2MP

Video Input / Output

Analog Camera Input	4 Channel, BNC
HDCVI Camera	5MP, 4MP, 1080P@25/30fps, 720P@50/60fps, 720P@25/30fps
IP Camera Input	4+2 Channel, each channel up to 6MP
Audio In/Out	1/1, RCA
Two-way Talk	Reuse audio in/out, RCA
Recording Compression	H.265+/H.265/H.264+/H.264
Recording Resolution	5M-N, 4M-N, 1080P, 1080N, 720P, 960H, D1, CIF
Record Rate	Main stream: the 1st channel 5M-N(1~10fps), other channels 4M-N/1080P(1~15fps); 1080N/720P/960H/D1/CIF (1~25/30fps) Sub stream: D1/CIF(1~15fps)
Bit Rate	32Kbps ~ 6144Kbps Per Channel
Record Mode	Manual, Schedule (General, Continuous), MD (Video detection: Motion Detection, Video Loss, Tampering), Alarm, Stop

Hard Disk Drive

Interface Type	1 SATA
Capacity	Up to 10TB

External Interface

Network interface	1 RJ-45 Port (100M)
USB	2 USB 2.0
RS485	1 Port, for PTZ Control

General

Application Support	Remote configuration, video browsing, local recording, local and remote playback
Motion Detection	Yes
Protocol Support	HTTP, HTTPS, TCP/IP, IPv4/IPv6, Wi-Fi, 3G/4G, SNMP, UPnP, RTSP, UDP, SMTP, NTP, DHCP, DNS, IP Filter, PPPoE, DDNS, FTP, Alarm Server, P2P etc.
Alarm Notification	Yes
Operation System	Linux-based
Power Supply	DC12V/2A
Power consumption	<10W (without hard disks)
Language Support	24 languages

NW-8CVI-8MP

Video Input / Output

Analog Camera Input	8 Channel, BNC
HDCVI Camera	4K, 6MP, 5MP, 4MP, 1080P@25/30fps, 720P@50/60fps, 720P@25/30fps
IP Camera Input	8+4 Channel, each channel up to 8MP
Audio In/Out	1/1, RCA
Two-way Talk	Reuse audio in/out, RCA
Recording Compression	H.265+/H.265/H.264+/H.264
Recording Resolution	4K, 6MP, 5MP, 4MP, 3MP, 4M-N, 1080P, 720P, 960H, D1, CIF
Record Rate	Main stream: 4K(1~7fps); 6MP(1~10fps); 5MP(1~12fps); 4MP/3MP(1~15fps); 4M-N/1080P/720P/960H/D1/CIF(1~25/30fps) Sub stream:960H(1~15fps); D1/CIF(1~25/30fps)
Bit Rate	32Kbps ~ 6144Kbps Per Channel
Record Mode	Manual, Schedule (General, Continuous), MD (Video detection: Motion Detection, Video Loss, Tampering), Alarm, Stop

Hard Disk Drive

Interface Type	1 SATA
----------------	--------

Capacity Up to 10TB

External Interface

Network interface 1 RJ-45 Port (1000M)
USB 2 USB Ports (1 USB 2.0,1 USB 3.0)
RS485 1 Port, for PTZ Control

General

Application Support Remote configuration, video browsing, local recording, local and remote playback
Motion Detection Yes
Protocol Support HTTP, HTTPS, TCP/IP, IPv4/IPv6, Wi-Fi, 3G/4G, SNMP, UPnP, RTSP, UDP, SMTP, NTP, DHCP, DNS, IP Filter, PPPoE, DDNS, FTP, Alarm Server, P2P etc.
Alarm Notification Yes
Operation System Linux-based
Power Supply DC12V/2A
Power consumption <10W (without hard disks)
Language Support 24 languages